

REV	CONTENT	CHK	DATE
V0.0	CONTENT	CXL	20.05.20
V0.1	增加识别圆点	CXL	21.01.03

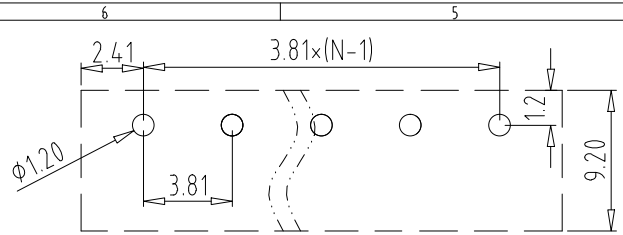

PCB LAYOUT

Electrical :

- | | | |
|--|-----------------|------|
| | UL | IEC |
| 1. Rated Voltage : | 300V | 250V |
| 2. Rated Current : | 8A | 7A |
| 3. Withstanding Voltage : | AC1600V/1Min; | |
| 4. Operating Temperature : | -40 °C~+105 °C; | |
| 5. RoHS Compliance; | | |
| 6. Safty Approval : | | |
| 7. "★" is the key quality control point. | | |

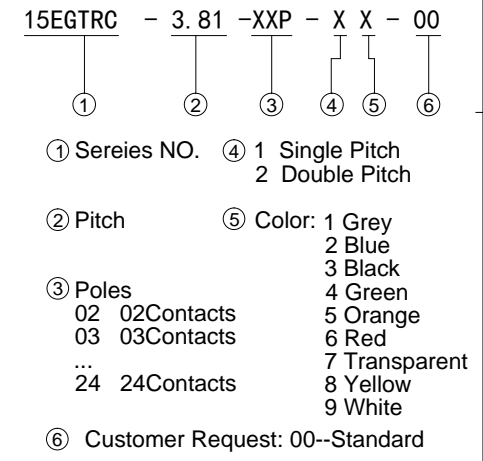
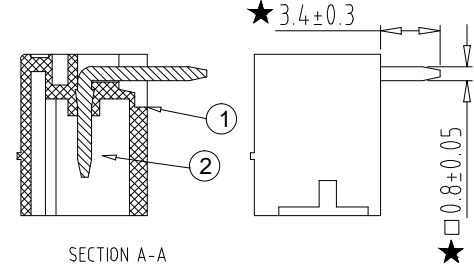
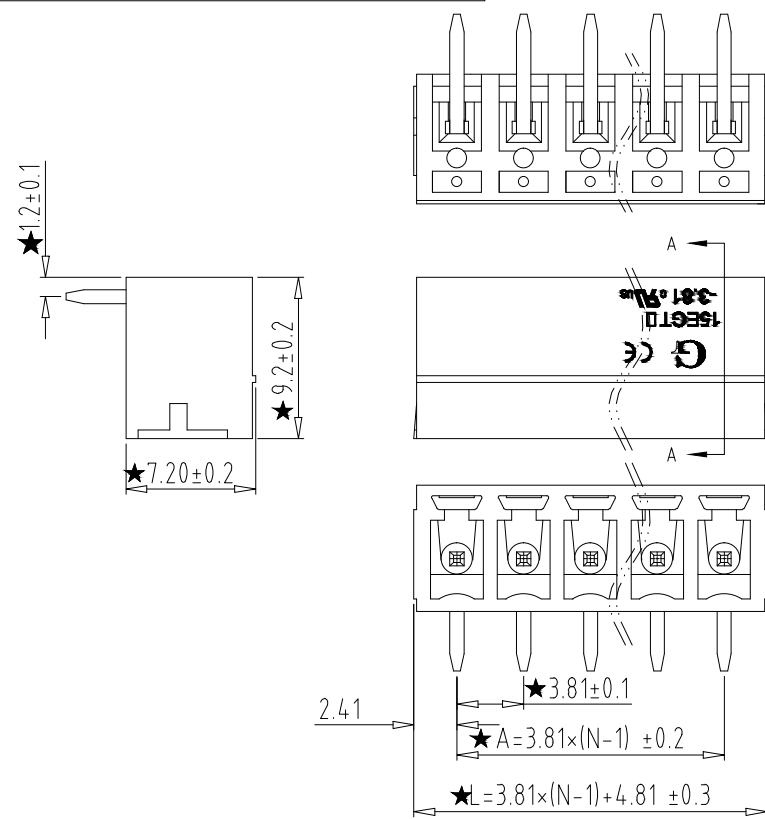

Total Pitch Tolerances in mm										Nominal dimension range in mm													
over	over	over	over	over	over	over	over	over	over	over	over	over	over	over	over	over	over	over	over	=	//	over	over
0	30	53	70	90	115	150	250	350	500	0	30	53	70	90	115	150	200	250	320	0	over	0	100
to	to	to	to	to	to	to	to	to	to	to	to	to	to	to	to	to	to	to	to	to	to	to	150
±0.18	±0.20	±0.25	±0.3	±0.35	±0.44	±0.60	±0.85	±0.20	±0.25	±0.30	±0.35	±0.44	±0.55	±0.70	±0.80	±0.90	0.2	0.3	0.3	0.2	0.3	0.5	0.5

2	PIN	XX	P	BRASS	Tin Plated
1	HOUSING	XX	1	PA66 UL94V-0	SEE NOTE
ITEM	NAME OF PART	NO. OF PART	Q'TY	MATERIAL	NOTE
DWG.	CXL	DATE	20.05.11	SIZE	A4 UNITS mm SHEET/OF 1 / 1
CHK.	DATE		SCALE	1:1	
APP.	DATE		NAME	15EGTRC-3.81-XXP-XX-00	
			DWGNO.	XXXX	